

Gilford School District Update on Opening Schools

August 18, 2020

Agenda

Elementary update

Middle School Update

High School Update

Special Education Update

Mitigation of Risk information

Protocols update

Decision making resources

Staffing and financial updates

Special Education and Title One

Providing services - OT, PT, speech, ELL,

Supporting all students

Supporting remote learners

Supporting math and literacy needs (k-4) (5-8) (9-12)

Elementary

Schedule update

- In person learners - [numbers in classrooms](#)
- Remote Learners - 53 remote learners
 - 3 Teachers:
 - K-1 Teacher = 17 learners (7) Kindergarten/(10) 1st grade
 - 2-3 Teacher = 18 learners (11) 2nd grade/ (7) 3rd grade
 - 3-4 Teacher = 18 learners (8) 3rd grade/ (10) 4th grade
 - Specials would be provided
 - Change in [class sizes](#) after remote teachers are taken out
- Band, chorus = phase II/ Instrument lessons
- Building protocols - drop off/pick up 5 different entrances/lunch in classroom
- Classrooms - desks 4-6 feet apart
- After school care / offerings

Drop Off/Pick UP

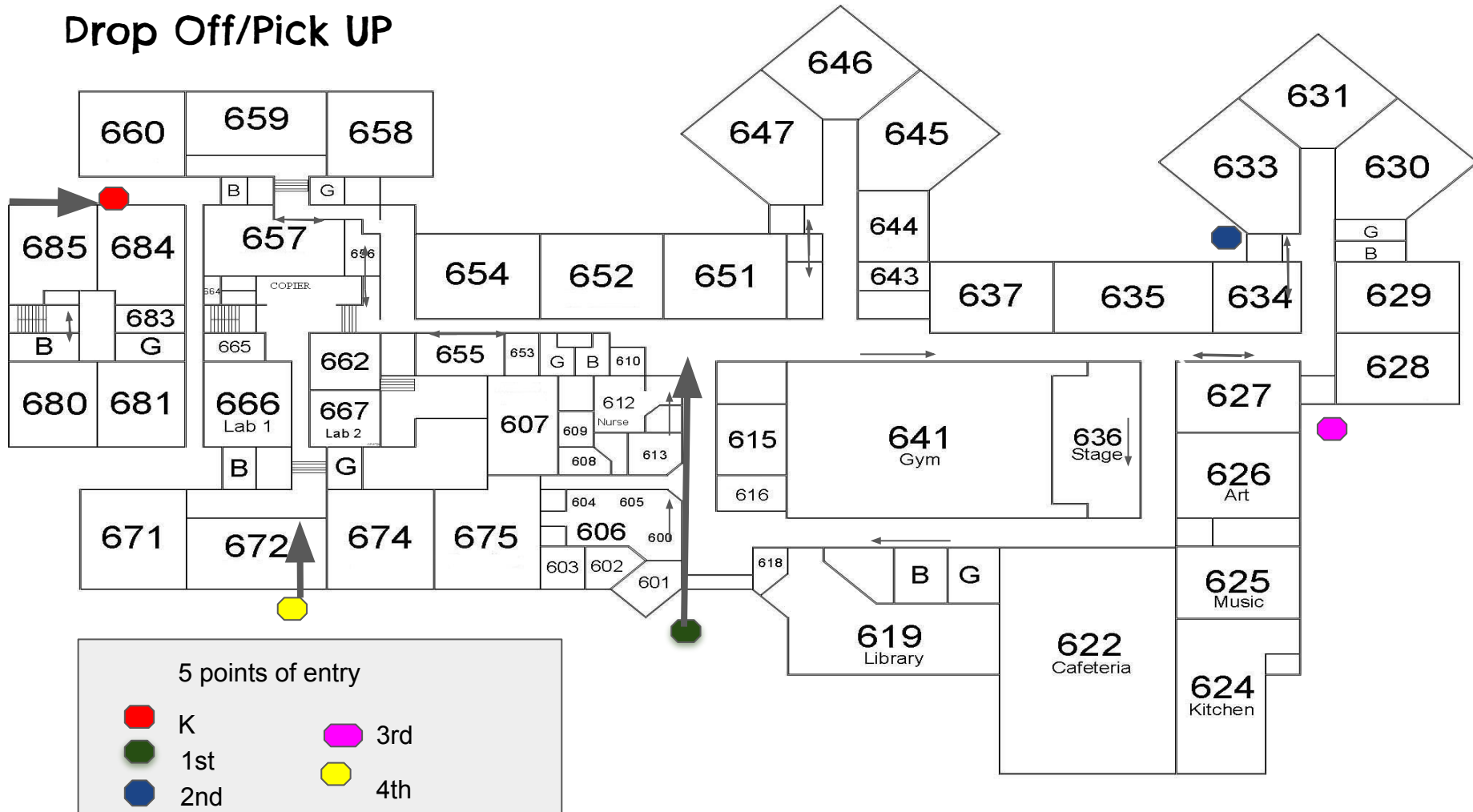

Middle School

Schedule update

- In person Learners - numbers in classrooms
- Remote Learners - numbers and groupings
- Staffing
- Band, chorus, PE
- Lunch
- Building protocols
- Classrooms - spacing
- After school offerings
- Athletics

High School

Schedule update

- In person Learners - numbers in classrooms
- Remote Learners - numbers and groupings
- Staffing
- Band, chorus, PE
- Lunch
- Building protocols
- Classrooms - spacing
- After school offerings
- Athletics

Mitigation of Risk - Multi levels of safety/precaution

Screening protocol

- Secondary screening

Social Distancing - signage purchased, on hand

Mask usage/protocol

Plexiglass - ordered

Sanitation - on hand

Disinfecting sprayers - on hand

Mask

- Face coverings/Masks - cloth face coverings must be worn
 - [CDC Guidelines on masks](#)
- Can I walk around the classroom and work with students?
 - Yes, both students and staff should be wearing a face covering/mask
- How will students be trained on how to wear and handle the mask? This should happen in the first week of school. [How to Safely Wear and Take Off a Cloth Face Covering](#)

Mask Break

- During natural break time in the day. During instructional transitional times. Every period MS/HS we will provide a mask break. Mask breaks can happen in the classrooms if we can provide six feet of social distancing. Mask breaks can also happen outside, in gymnasiums, in the auditorium, in libraries and other large spaces in our buildings.

Self Screening

Temperatures will need to be taken and be recorded. If a person has over a 100.0 F temperature they will need to stay home. A screening checklist will be provided for each family.

- All employees and students will answer 6 questions:
- A. Are you experiencing any of the following respiratory symptoms: cough, shortness of breath, sore throat, or runny nose?
- B. Have you had a fever or felt feverish in the last 72 hours?
- C. Have you been in close contact with someone with a confirmed diagnosis of COVID-19, or who is under investigation for COVID-19?
- D. Are you experiencing any new muscle aches or chills?
- E. Have you experienced any new change in your sense of taste or smell?
- F. Have you traveled in the prior 14 days outside of New England (VT, ME, MA, CT, RI)?

Travel

- Can you clarify the travel/quarantine requirements for staff? If you travel outside of New England (VT, ME, MA, CT, RI), you will need to quarantine for 14 days. [DHHS employee travel guidance](#)
- [Travel during the COVID-19 Pandemic](#)
- [Possible exemption to quarantine](#)

Scenario Updates

- A person in classroom / office area has symptoms:
 - Provide written documentation of negative PCR or antigen test result (in accordance with NH DPHS guidance) AND person is fever-free, without fever-reducing medication, for at least 24 hours and other symptoms are improving (per routine school policy),
 - If symptoms are new and testing is not conducted, treat the individual as a suspected COVID-19 infection and allow return to school after CDC criteria are met for removal from home isolation. Currently requires 10 days since onset of symptoms, and when symptoms improved and fever-free for 24 hours without fever reducing medication, and district return to school protocols are met
 - [Disposition of Non-Hospitalized Patients with COVID-19](#)

Scenario continued

- A person has been in close contact with a confirmed case in the last 14 days:
 - Report to NH DHHS
 - Exclude from school
 - Advise to contact health care provider for PCR or antigen test
 - School nurse or COVID coordinator will monitor absence line list and timeline for return to school
 - Advise individual to follow NH DHHS guidance: Refer to Coronavirus Disease Self-Quarantine Guide [DHHS self quarantine](#)
 - Individual must self-quarantine for 14 days from last exposure, and provide medical or public health documentation that quarantine has been met
 - Individual cannot test out of 14-day self-quarantine in NH

Scenarios Continued

- A person has been in close contact with a suspected case in the last 14 days:
 - Exclude from school
 - Siblings of students who are undergoing testing for mild non-specific symptoms do not need to be excluded
 - Siblings of students who are undergoing testing for highly suspect symptoms should be excluded from school
 - School nurse or covid coordinator will monitor absence line list and timeline for return to school
 - Consult with NH DPHS, if needed
 - Refer to Coronavirus Disease Self-Quarantine Guide (NH DPHS) [Self quarantine guide](#)
 - If person suspected of COVID-19 undergoes PCR or antigen testing (in accordance with NH DPHS guidance) and result is negative, individual in close contact may return to school
 - If suspected case is not tested, then student in close contact should self-quarantine for 14 days from last day of exposure to the individual, unless otherwise specified by NH DHHS

Scenario continued

- Someone is found to have COVID-19:
 - Advise person with suspected or confirmed COVID-19 to isolate at home and contact health care provider
 - Persons suspected of COVID-19 should be directed to get PCR or antigen tested for COVID-19 (in accordance with NH DPHS guidance)
 - Consult with NH DPHS for guidance
 - NH DPHS will work with school nurse or identified point of contact at the school to determine close contacts and decide who will need to self-quarantine
 - NH DPHS will work with schools to notify and inform parents/guardians, students, and other staff of any exposures to people confirmed to have COVID-19
 - Inform building administration
 - Follow facility cleaning and disinfection recommendations from CDC.
 - Refer to Coronavirus Disease Self-Isolation Guide (NHDPHS) [DHHS self isolation guidance](#)
 - Refer to Coronavirus Disease Self-Quarantine Guide (NHDPHS) [DHHS self quarantine](#)
 - Individual with COVID-19 can return to school after CDC criteria are met, and provides medical or public health documentation that self isolation requirement has been met [Disposition of Non-Hospitalized Patients with COVID-19](#)
 - A follow-up negative test is not required for return to school

Decision making resources

Local Health Officer

Decision making metrics to review:

[NH Department of Health and Human Services Dashboard](#)

[Harvard Global Health Institute Dashboard](#)

Staffing and financial considerations

High school sections / extra 11th

Plexiglass barriers for students

Plexiglass barriers for band/chorus

Possible tent

Picnic table update - waiting to connect with town

- Possible left over tables at Lowes?